

## Elbow 90°

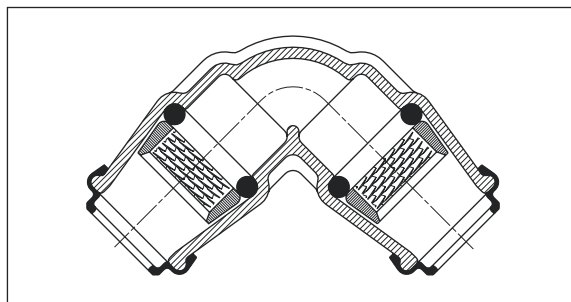

**No. 6400** of grey iron

**No. 6420** of POM

Special dimensions

**No. 6490** of POM

Pipe Ø mm	Order No. 6400		Order No. 6420	
		Weight kg		Weight kg
20	●	0,30	●	0,06
25	●	0,45	●	0,10
32	●	0,80	●	0,18
40	●	1,20	●	0,37
50	●	1,90	●	0,52
63	●	3,00	●	0,80

Pipe Ø 1 mm	Pipe Ø 2 mm	Order No. 6490	
			Weight kg
32	25	●	0,13
40	32	●	0,25

## Elbow 90° with female thread

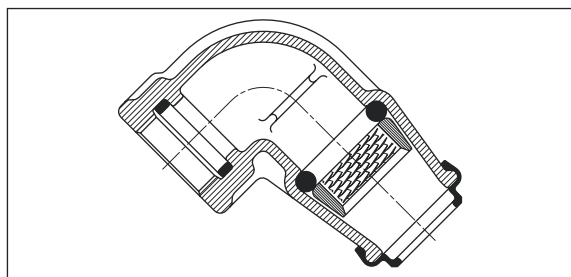

**No. 6410** of grey iron

**No. 6430** of POM

Pipe Ø mm	Thread	Order No. 6410		Order No. 6430	
			Weight kg		Weight kg
20	½"			●	0,07
25	¾"	●	0,38	●	0,10
32	1"	●	0,65	●	0,14
40	1¼"	●	0,98	●	0,28
50	1½"	●	1,50	●	0,42
63	2"	●	2,20	●	0,67

## Elbow 90° with male thread

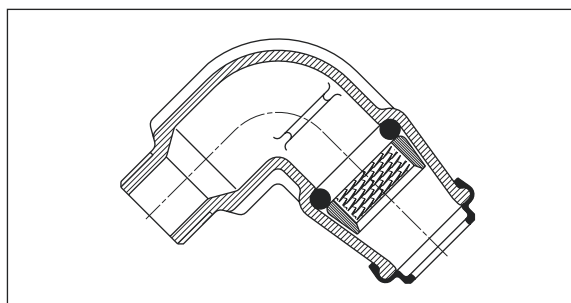

**No. 6460** of grey iron (32/1" of ductile iron)

Special dimensions

**No. 6470** of grey iron

Pipe Ø mm	Thread	Order No. 6460	
			Weight kg
25	¾"	●	0,40
32	1"	●	0,65
40	1¼"	●	1,10
50	1½"	●	1,70
63	2"	●	2,25

Pipe Ø mm	Thread	Order No. 6470	
			Weight kg
32	1¼"	●	0,60
32	1½"	●	0,90
40	1½"	●	1,10

## Elbow 45° with male thread

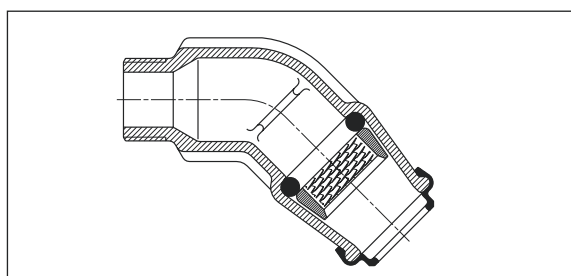

**No. 6411** of grey iron

Pipe Ø mm	Thread	Order No. 6411	
			Weight kg
32	1"	●	0,60
50	1½"	●	1,45
63	2"	●	1,90

# ISO Pipe Fitting

## Elbow 90°

Swivelling fitting, with male Thread

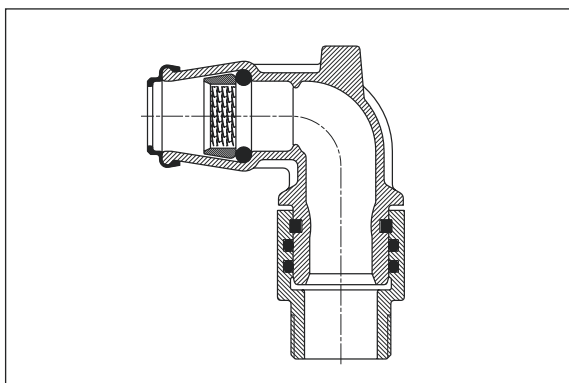

**No. 6462** of grey iron

Pipe Ø mm	Thread	Order No. 6462	
			Weight kg
50	1½"	●	2,00
63	1½"	●	2,65

## Tee with female thread outlet

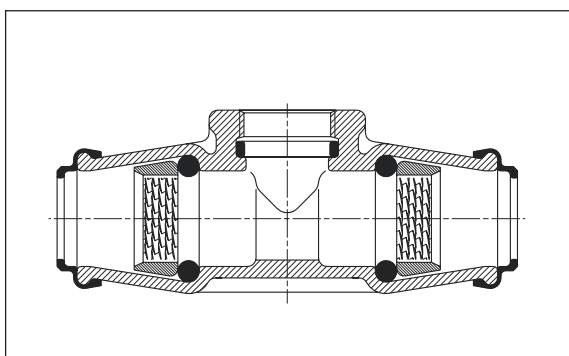

**No. 6500** of grey iron

**No. 6520** of POM

Special dimensions

**No. 6510** of grey iron

Pipe Ø mm	Thread	Order No. 6500		Order No. 6520	
			Weight kg		Weight kg
20	½"	●	0,38	●	0,10
25	¾"	●	0,56	●	0,15
32	1"	●	0,83	●	0,22
40	1¼"	●	1,45	●	0,43
50	1½"	●	2,20	●	0,60
63	2"	●	3,70	●	0,90

Pipe Ø mm	Thread	Order No. 6510	
			Weight kg
50	2"	●	2,40
75	1"	●	5,20
75	2"	●	4,60

## Tee with female thread outlet, with detachable ends for subsequent assembly

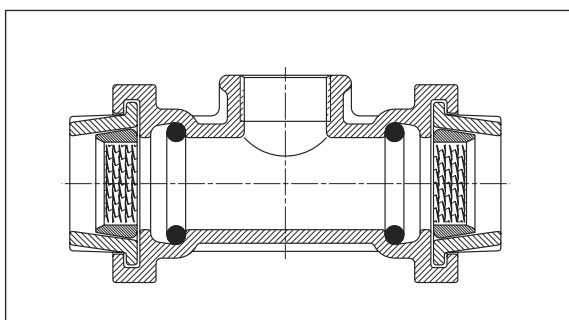

**No. 6501** of grey iron

Pipe Ø mm	Thread	Order No. 6501	
			Weight kg
32	1"	●	1,50
40	1¼"	●	2,40
50	1½"	●	2,70
63	2"	●	4,10

if used as sleeve - Attention: no stop !