

Order no.	Version	Application	PN	Dimensions/DN										
				50	65	80	100	125	150	200	250	300	400	
4100E2	standard length	Water, non aggressive effluent other applications on request !	16	●	●	●	●	●	●	●	●	●	●	●
4140E2	Length 600 mm					●	●	●	●					

Resilient seated gate valve with smooth straight-through bore

of ductile iron

epoxy powder coated

The **Hawle E2 Valve** with smooth spigot ends is a universal design suitable for both flange and socket connections.

Makes easy the replacement of old valves with flanged ends; if Hawle flanges are used on the valve spigot ends, then flat gaskets are not necessary.

Face-to-face dimension of the valve can be adjusted by shortening the spigots.

The outside diameters of the spigots are the same as those of cast iron pipes; (other sizes on request).

Material and design features:

- 1/2 **Body (1) and Bonnet (2)** of ductile iron EN-GJS-400-18 according to EN 1563 (GGG 400 - DIN 1693) inside and outside epoxy powder coated according to DIN 30677-T2 in accordance with DIN 3476 and all quality and test requirements of RAL quality mark 662 (GSK - Gütegemeinschaft Schwerer Korrosionsschutz - the association for high quality corrosion protection)
- 3 **Stainless steel spindle** St 1.4021 (X20Cr13), with rolled thread
- 4 **Wedge** of ductile iron EN-GJS-400-18 according to EN 1563 (GGG 400 - DIN 1693), inside and outside fully rubberized with vulcanized elastomer, suitable for potable water, with drain hole
- 5 **Wedge guide** of wear resistant plastic with high gliding features; optimally placed design guarantees lowest wear and tear and lowest closing torques
- 6 **Wedge nut** of dezincification resistant brass CuZn36Pb3As, generous oversizing of the required thread length in the wedge nut guarantees highest possible breaking torques
- 7 **O ring bush** of Ms 58
- 8 **O rings** of elastomer, embedded in non-corrosive material (according to DIN 3547-T1) and replaceable under pressure (according to ISO 7259) up to DN 200, for DN 250 and higher without pressure
- 9 **Back seal** of elastomer, suitable for potable water
- 10 **Circlip** of POM
- 11 **Wiper ring** of elastomer
- 12 **Bonnet gasket** of elastomer, suitable for potable water
- 13 **Allen screws** St 8.8 DIN 912 absolutely corrosion protected by being sunk into the body and sealed, and by passing through bonnet gasket
- 14 **Edge protecting ring** of PE avoids damages during transport and storage
- 15 **Friction washers** of POM guarantee smooth spindle guiding

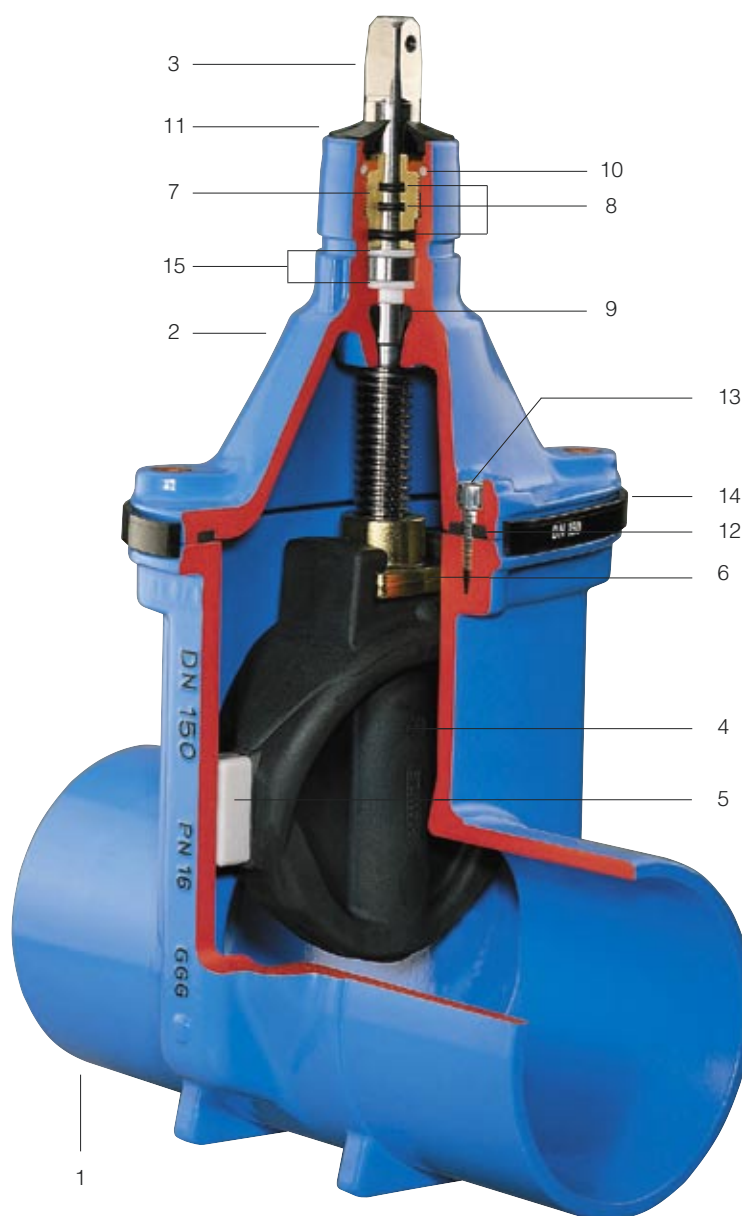

E2 Valve Spigot Ends

Standard version: without handwheel and extension spindle

Special versions: for example: **restraint type on request !**

Suitable accessories: **Handwheel:** No. 7800

Extension Spindles: rigid No. 9000E2, for DN 250 and higher No. 9000
telescopic No. 9500E2, for DN 250 and higher No. 9500

Surface Boxes: rigid No. 1750, telescopic No. 2050

Design features:

- easiest retrofitting of position indicator and automatic actuator on the standard bonnet possible
- one extension spindle for several dimensions
- optimally placed wedge guide of wear resistant plastic guarantees lowest wear and tear and lowest closing torques, suitable for frequent operations at a differential pressure up to 16 bar
- 100 % suitable for operation by automatic actuators
- generous oversizing of the required thread length in the wedge nut guarantees highest possible breaking torques
- O rings embedded in non-corrosive material (according to DIN 3547-T1)
- replaceable O rings
 - up to DN 200 under pressure (according ISO 7259)
 - from DN 250 without pressure
- cleaning with pig possible

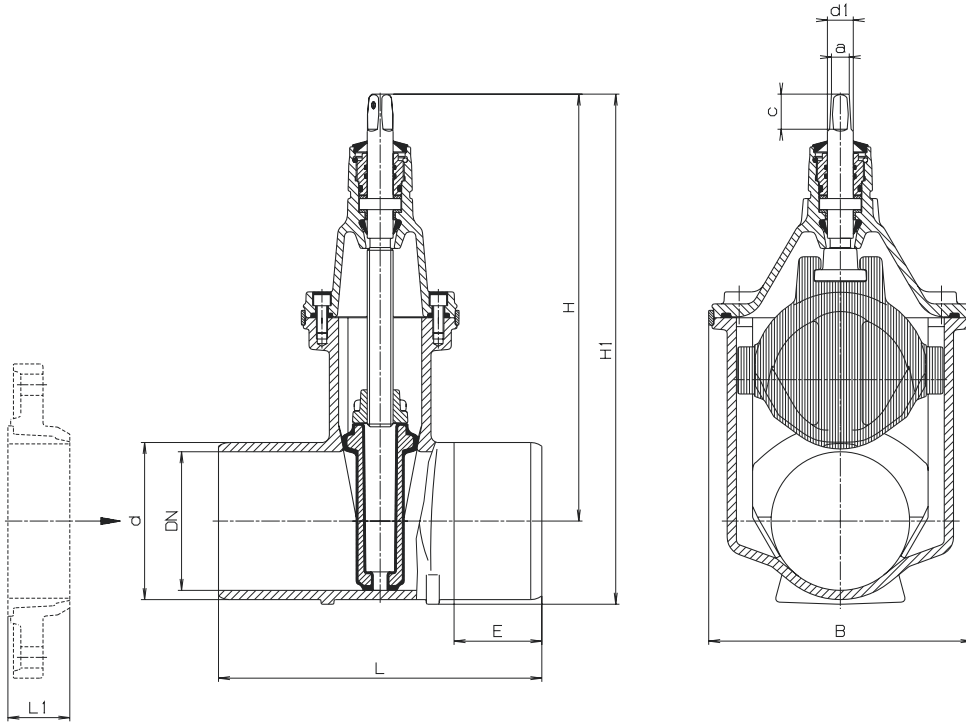

For a shorter face-to-face dimension, shorten the spigot ends and assemble with HAWLE flanges (see "Flanges" in the catalogue index).

Note: ensure that spigot length "E" is not less than flange body depth "L 1".

DN	Valve						Spindle			Weight kg
	d*	L	E	H	H1	B	a	c	d 1	
50	66	250	80	260	296	143	14,8	30	22	7,8
65	82	270	85	328	373	180	17,3	35	25	13,0
80	98	280	85	336	390	180	17,3	35	25	14,5
		600	245							19,5
100	118	300	90	373	438	213	19,3	38	25	20,0
		600	240							26,0
125	144	325	95	450	527	285	19,3	38	28	30,0
150	170	350	95	462	552	285	19,3	38	28	34,5
		600	220							41,5
200	222	400	115	563	679	357	24,3	48	32	55,5
		600	215							65,0
250	274	450	120	670	813	432	27,3	48	34	93,0
300	326	500	120	753	919	518	27,3	48	34	137,0
400	429	600	133	974	1198	687	32,3	55	44	254,0

* other outside diameters on request