

Fittings for PE pipes (DIN 8074/8075) up to PN 10

**total restraint - low insertion force - easy to dismantle**

The pipe is sealed with two separate sealing components, a lip seal, and an O ring which is compressed by tightening the lock ring.

Due to the combination of these sealing components, only a low pipe insertion force is required.

The pipe restraining system is separated from the sealing system and is activated by tightening the lock ring.

for GAS

according to EN 437

Connector		Bend			End cap		
Pipe Ø		Pipe Ø	90°	45°	30°	Pipe Ø	
63	●	63	●	●		63	●
75	●	75	●	●		75	●
90	●	90	●	●	●	90	●
110	●	110	●	●	●	110	●
125	●	125	●	●		125	●
140	●	140	●	●		140	●
160	●	160	●	●	●	160	●
180	●	180	●	●		180	●
200	●	200	●	●		200	●
225	●	225	●	●		225	●
250	●	250	●	●		250	●
280	●	280	●	●		280	●
315	●	315	●	●		315	●

**Material:**

**Body (1) and locking ring (5)**

of ductile iron EN-GJS-400 EN 1563 epoxy powder coated

**Lip seal (2)**

elastomer - DIN 3535

**Spacer bush (3)**

PE

**Grip ring (4)**

Ms 58 (DN 300 Rg 7)

**Bolts (6)**

A 2 (stainless)

**O ring holder (8)**

ductile iron EN-GJS-400 EN 1563 epoxy powder coated,  
O ring of elastomer - DIN 3535

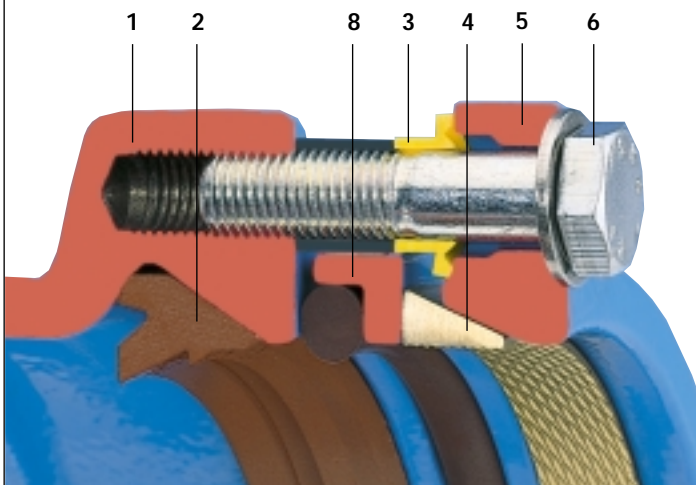

**Use a support liner !** see page D 3/1

**Assembly instruction** see page J 1/1

**Tensile load** see page J 1/2

**Connector No. 0435**

The centre stop ring can be removed and the fitting used as a slip coupling (U) - chamfer the pipe strongly !



Bend 90° No. 8536 / 45° No. 8546 / 30° No. 8556

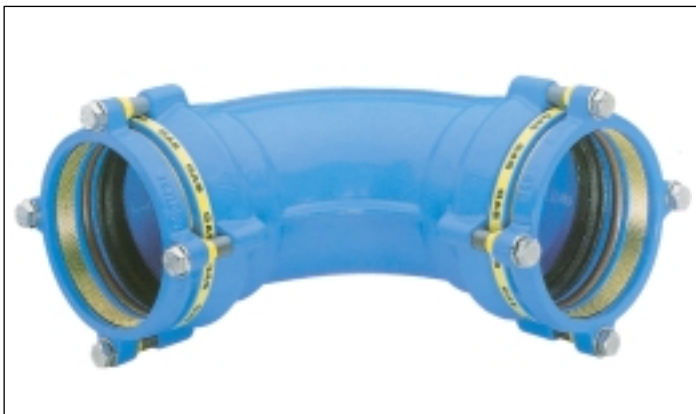

**End cap No. 8076** with threaded outlet for pipe flushing or test point, etc.



No. 0435  
**Connector**

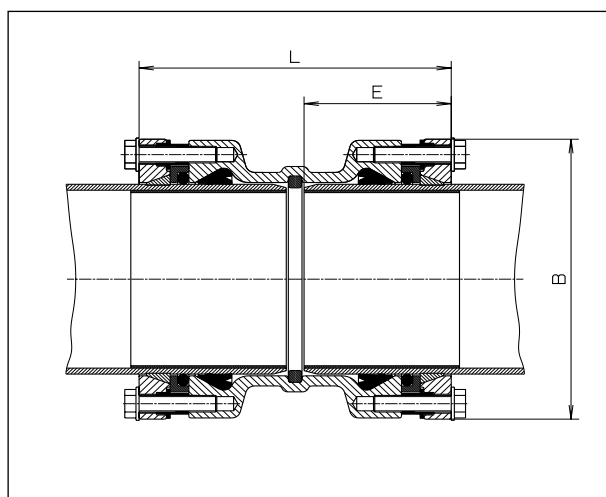

DN	L	E	B	Weight
63	195	92	124	3,6
75	201	95	138	4,4
90	207	98	152	5,9
110	205	97	172	6,9
125	215	102	193	8,2
140	227	108	210	9,8
160	255	122	236	14,2
180	275	130	258	20,5
200	295	142	284	25,0
225	305	148	314	27,5
250	340	165	347	35,5
280	346	168	376	41,0
315	402	196	422	62,0

No. 8536  
**Bend 90°**

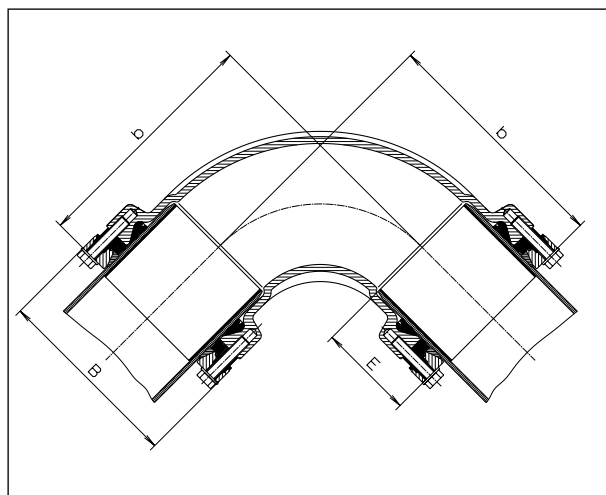

No. 8546  
**Bend 45°**

No. 8556  
**Bend 30°**

DN	b			E	B	Weight kg		
	90°	45°	30°			90°	45°	30°
63	165	123		92	124	4,6	4,6	
75	183	133		95	138	6,0	5,5	
90	201	142	127	98	152	7,7	6,9	6,5
110	225	152	134	97	172	10,0	8,1	7,8
125	255	168		102	193	13,3	10,8	
140	261	174		108	210	15,0	13,5	
160	300	198	172	122	236	23,5	17,5	17,0
180	310	208		130	258	25,5	21,0	
200	370	238		142	284	38,0	33,0	
225	375	244		148	314	45,5	41,5	
250	447	283		165	347	63,0	52,0	
280	450	286		168	376	74,0	56,0	
315	528	335		196	422	107,0	85,5	

No. 8076  
**End cap**

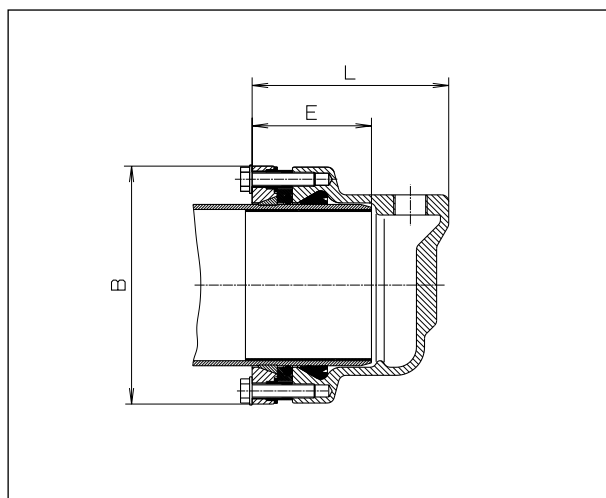

DN	L	E	B	Weight
63	118	92	124	3,0
75	151	95	138	3,8
90	154	98	152	4,8
110	171	97	172	6,4
125	177	102	193	6,9
140	184	108	210	7,9
160	197	122	236	9,9
180	209	130	258	12,5
200	220	142	284	17,0
225	227	148	314	19,0
250	245	165	347	23,0
280	248	168	376	28,5
315	276	196	422	36,0