

for GAS according to EN 437



REG. NR. G 2.426

The prescribed pressure test for gas valves will be attested by certificate in accordance with DIN 50049 (EN 10204) - 3.1.B.

Order no.	Application	PN	Dimensions/DN				
			3/4"	1"	1 1/4"	1 1/2"	2"
2505	female iron threads both ends	4	●	●	●	●	●
2525	1 female thread 1 male thread	4		●	●	●	●

Design features:

- multiple O ring spindle seals
- stainless steel spindle
- unobstructed waterway
- wedge encapsulated with vulcanized elastomer - DIN 3535
- threaded connection for extension spindles
- allen screws absolutely corrosion protected by being sunk into the body and sealed, and by passing through flat gasket

Sealing system:

The contact between wedge and body is friction free.
Therefore no scuffing or abrasion of the wedge.

No. 2505



No. 2525



Material:

Body and bonnet:

of ductile iron EN-GJS-400-18, according to EN 1563 (GGG 400 - DIN 1693) inside and outside epoxy powder coated

Wedge:

CuZn39Pb3 (Ms 58)
wedge rubber elastomer - DIN 3535

Spindle:

stainless steel 1.4021 (X20 Cr13)

O ring bush:

of Ms 58, corrosion-proof spindle bushing - DIN 3547

Service Valve

Suitable handwheel: No. 7800

Suitable extension spindles: rigid No. 9101 – telescopic No. 9601

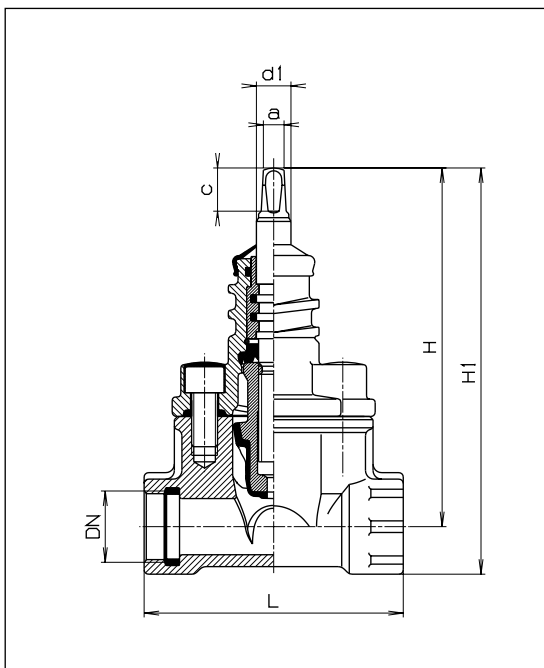

No. 2505
Service Valve
female thread both ends

DN	Valve			Spindle			Weight kg
	L	H	H1	a	c	d1	
3/4"	120	164	184	10,3	20	16	2,60
1"	120	164	188	10,3	20	16	2,50
1 1/4"	140	200	229	10,3	20	16	4,20
1 1/2"	140	200	232	10,3	20	16	4,40
2"	150	219	258	10,3	20	16	5,20

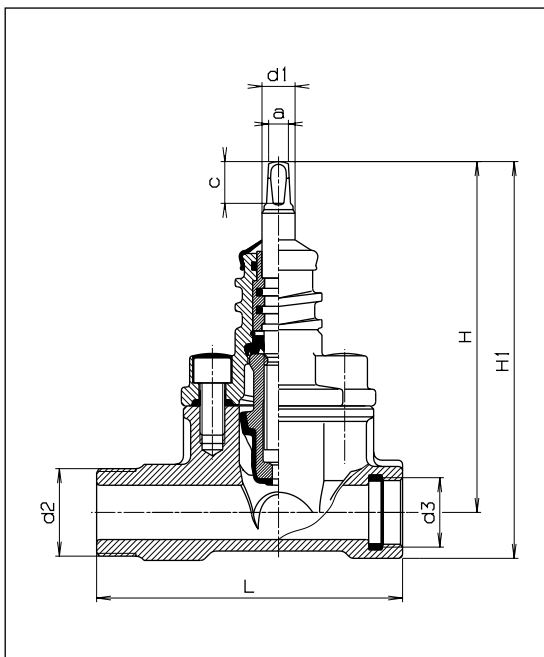

No. 2525
Service Valve
with one female and one male thread

DN	Valve					Spindle			Weight kg
	L	H	H1	d2	d3	a	c	d1	
1"	148	164	191	1 1/4"	1"	10,3	20	16	2,80
1 1/4"	167	200	234	2"	1 1/4"	10,3	20	16	4,70
1 1/2"	167	200	238	2"	1 1/2"	10,3	20	16	4,80
1 1/2"	167	200	238	1 1/2"	1 1/2"	10,3	20	16	4,80
2"	172	219	264	2"	2"	10,3	20	16	5,20