

for GAS according to EN 437



REG. NR. G 1.475

The prescribed pressure test for gas valves will be attested by certificate in accordance with DIN 50049 (EN 10204) -3.1.B.

Order no.	Face-to-face dimension	PN	Dimension/DN			
			20	25	32	40
4005	short (DIN 3202 F 4) EN 558-1 GR 14	4	•	•	•	•
4705	long (DIN 3202 F 5) EN 558-1 GR 15	4			•	•

Resilient seated gate valve with smooth straight-through bore

Material and design features:

1/2 **Body (1) and bonnet (2)** of ductile iron EN-GJS-400-18 according to EN 1563 (GGG 400 - DIN 1693) inside and outside epoxy powder coated according to DIN 30677-T2 in accordance with DIN 3476 and all quality and test requirements of RAL quality mark 662 (GSK - Gütegemeinschaft Schwerer Korrosionsschutz - the association for high quality corrosion protection)

3 **Stainless steel spindle** St 1.4021, with rolled thread

4 **Wedge** with vulcanized elastomer - DIN 3535 with drain hole
DN 20 - 25 of Ms 58 DIN 17660
DN 32 - 40 of Rg7 DIN 1705

7 **Bush** of Ms 58 - DIN 17660, solid spindle support of drawn brass

8 **O rings** of elastomer - DIN 3535 the perfect spindle seal

9 **Back seal** of elastomer - DIN 3535

10 **Circlip** 1.4301

11 **Wiper ring** of elastomer

12 **Bonnet gasket** of elastomer - DIN 3535

13 **Allen screws** St 8.8 DIN 912 absolutely corrosion protected by being sunk into the body and sealed, and by passing through bonnet gasket

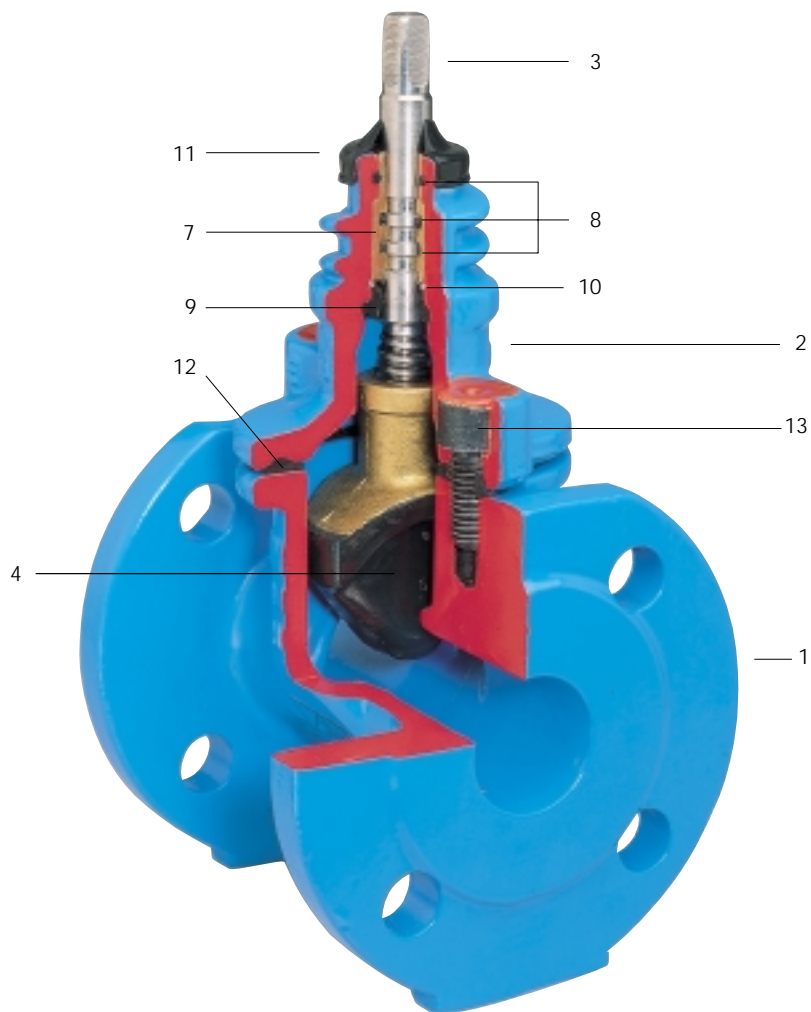

Flanges according to EN 1092-2 (DIN 28605), drilled to DIN 2501- PN10

Elypso Valve Flanged Ends DN 20-40

The Hawle Elypso valve is constructed plainly and made up of a limited number of components.

Sealing system: The contact between wedge and body is **friction free**. Therefore no scuffing or abrasion of the wedge.

Standard version:

Drilled to PN 10 - DIN 2501;
without handwheel and extension spindle

Special versions on request

Suitable handwheel: No. 7800

Suitable extension spindles:

rigid No. 9101, telescopic No. 9601

Suitable surface boxes:

rigid No. 1755
telescopic No. 2055

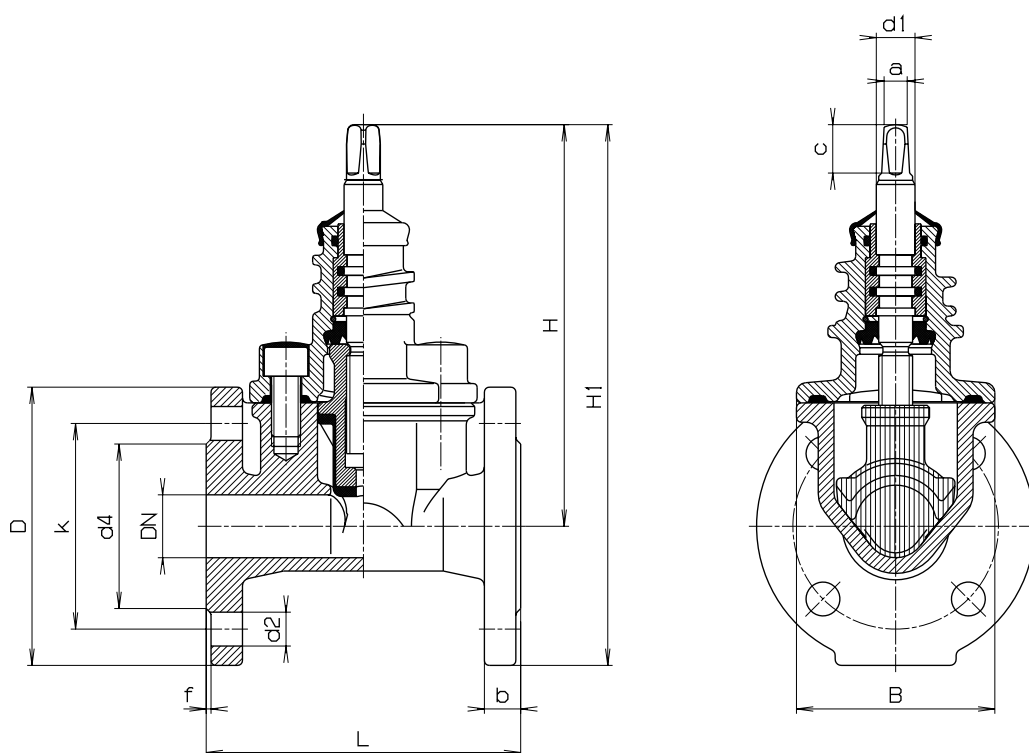

DN	Flange					Bolts			Spindle			Valve					Weight kg	
	D	b	k	d 4	f	Qty.	Thread	d 2	a	c	d 1	H	H 1	L-No.		B	short	long
														short	long			
20	115	16	75	58	2	4	M 12	14	10,3	20	16	164	223	130		80	4,5	
25	115	16	85	68	2	4	M 12	14	10,3	20	16	164	223	130		80	4,5	
32	150	18	100	78	2	4	M 16	18	10,3	20	16	200	275	140	240	103	7,0	8,5
40	150	18	110	88	2	4	M 16	18	10,3	20	16	200	275	140	240	103	7,0	8,5